



I N S T R U C T I O N M A N U A L

ITEMS YOU WILL NEED TO PURCHASE TO BE ABLE TO OPERATE YOUR TOWER POWER VEE

- 1 - **Battery Charger** – TOWP0100 AC/DC Auto Charger
- 1 - **Battery Pack** – TOWC1030 1500mAh Battery Pack
- 8 AA Batteries

SPECIFICATIONS

Length:	25.5"	[647mm]
Width:	9"	[227mm]
Height:	5.5"	[140mm]
Weight:	2 lb	[903g]

SAFETY!

Never attempt to swim after a stalled RC boat!

Never operate your RC boat while standing in the water.

Never operate your RC boat in the presence of swimmers.

Always use a Personal Flotation Device (PFD) when boarding and operating your retrieval craft, i.e. Jon boat, or duck boat. **Note:** Because of the sharp running hardware included with this RC boat we do not recommend a rubber blow up raft.

RC boat running hardware is very sharp.
Be very careful when working on and around the metal parts.

Tower Hobbies products are to be used by ages 14 and over.

Manual Specification & Description Changes:

All pictures, descriptions, and specifications found in this instruction manual are subject to change without notice.

TOWB03**
© 2010 Tower Hobbies





10 EASY STEPS TO FUN!

1



Charge the Battery

2



Install "AA" Batteries

3



Attach Hook & Loop to Battery

4

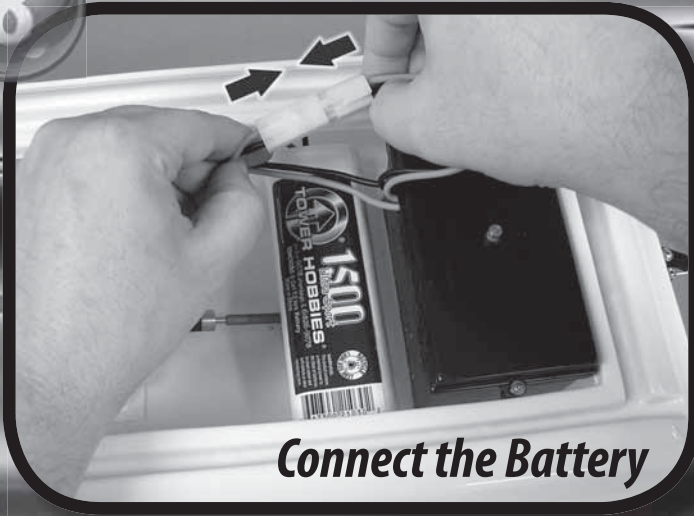

Connect the Battery

5

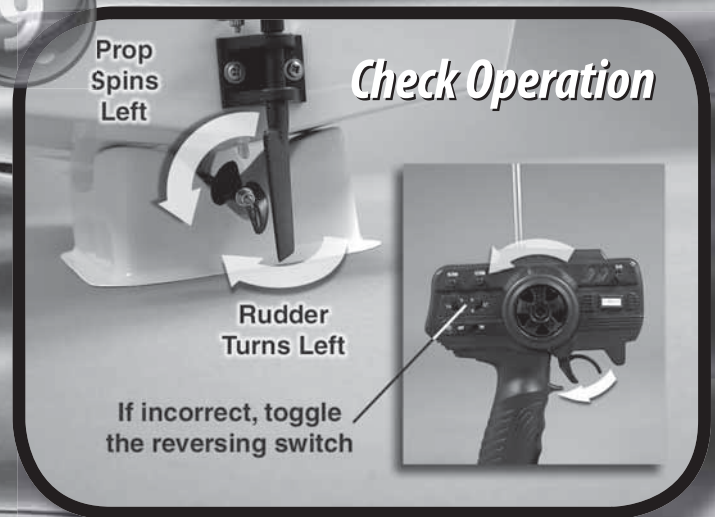

Check Operation

Prop Spins Left

Rudder Turns Left

If incorrect, toggle the reversing switch

2



Install the Decals

3

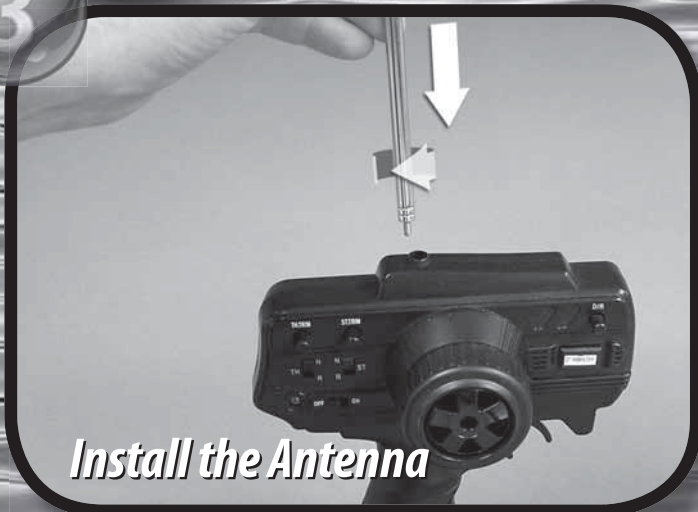

Install the Antenna

6



Replace batteries if flashing

Turn "On" the Radio

7



Install the Battery Into the Boat

10

GO HAVE FUN!



WARRANTY SERVICE

Tower Hobbies will warrant your Tower Power Vee for 90 days after the purchase from defects in materials or workmanship of original manufacture. Tower Hobbies, at their option, will repair or replace at no charge the incorrectly made part. This warranty does not cover damage caused by crash, abuse, misuse, alteration or accident. To return your boat for service you need to provide proof of purchase. IN NO EVENT SHALL THE PURCHASER BE ENTITLED TO ANY INCIDENTAL, SPECIAL, INDIRECT OR CONSEQUENTIAL DAMAGES, WHETHER RESULTING FROM THE USE, MISUSE OR INABILITY TO USE THE PRODUCT OR FROM DEFECTS IN THE PRODUCT. This warranty gives you specific legal rights and you may also have other rights, which vary from state to state.

MAINTENANCE

After a day of running it's a good idea to wipe up any water from the inside of the boat. Using a 1.5mm Allen wrench, loosen the set screw on the drive shaft coupler. Remove and oil the drive shaft. Make sure you fully tighten the coupler after you re-install the shaft. Leave the top cover off the boat over night to allow any excess moisture to fully evaporate.

CONTACT

Hobby Services

3002 N. Apollo Drive, Suite 1
Champaign, Illinois 61822
Attn: Service Department

Phone

(217) 398-0007
9:00 am - 5:00 pm
Central Time M-F

E-mail

hobbyservices@hobbico.com

PARTS LIST

TOWB4280 E.S.C.

TOWB7765 Propeller Set (2)

TOWB7851 Drive Shaft w/Coupler

TOWB7852 Drivedog w/Prop Nut

TOWB8705 Rudder w/Control Arm